

No.	DESCRIPTION	MATERIAL DESCRIPTION
1	BODY	CAST LOW LEAD BRASS ALLOY
2	CAP	CAST BRASS ASTM B62 ALLOY C83600
3	STEM	LOW LEAD BRASS ALLOY
4	BALL	LOW LEAD BRASS ALLOY
5	GASKET	NITRILE ASTM D2000
6	SOLID PIN	AISI 304 ANNEALED STAINLESS STEEL
7	O-RING	EP ASTM D2000
8	END PIECE	CAST LOW LEAD BRASS ALLOY
9	O-RING	EP ASTM D2000
10	HANDLE	CAST BRASS ASTM B62 ALLOY C83600
11	SCREW	AISI 304 STAINLESS STEEL
12	LOCKNUT	TYPE 18-8 STAINLESS STEEL

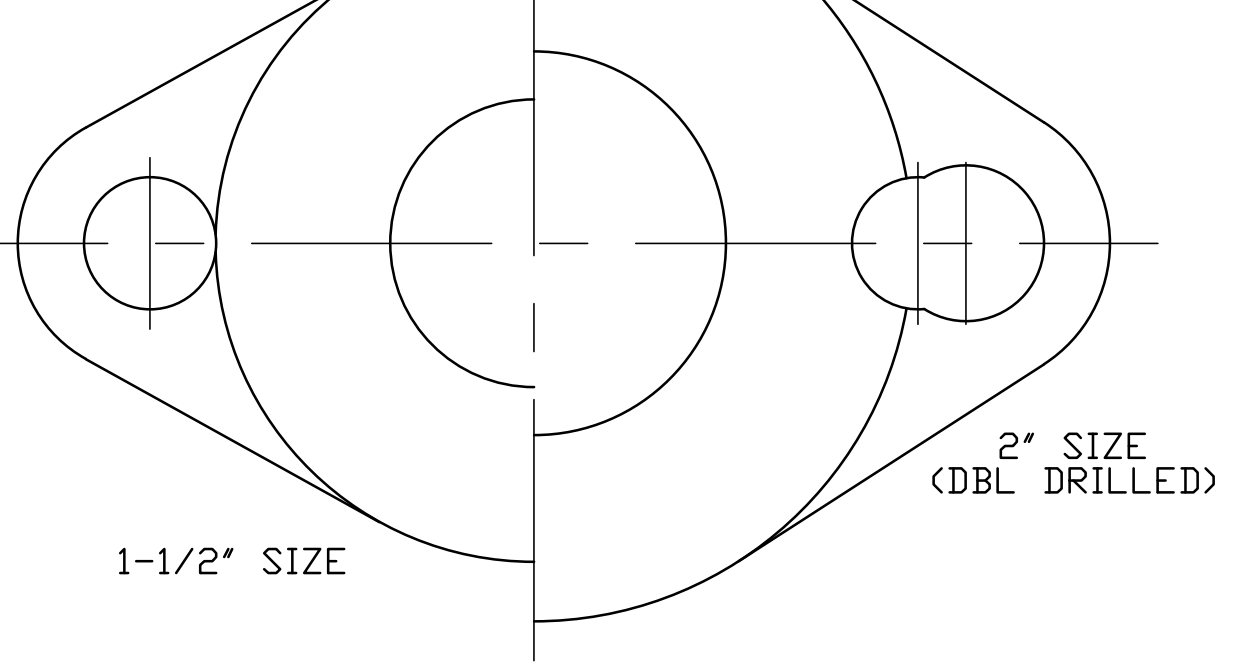

ALL WETTED PARTS ARE LOW LEAD BRASS ALLOY

VALVE SIZE	A	NPT SIZE
1-1/2"	4-3/4"	1-1/2"
2"	5-3/4"	2"

FILEPATH: PROD-ENG\JJ\SUBMITTALS\E1913WJ

REV	ECR	DESCRIPTION	DATE	BY	CHKR

JONES

UNLESS OTHERWISE NOTED THIRD ANGLE PROJECTION

SURFACE PREPARATION:
 BREAK CORNER(S) ---- .000
 SURFACE FINISH -- XX RMS

TOLERANCE(S):
 LINEAR ----- ± .000
 ANGULAR ----- ± 0°00'

REF. No. SCALE

DWG NUMBER
E1913WJ
JJ-MRKTNG

TITLE TO AND OWNERSHIP OF THIS ENGINEERING DATA REMAINS IN Mueller Co. NO USE IS TO BE MADE OF THIS DATA EXCEPT AS SPECIFICALLY AUTHORIZED BY Mueller Co. ASSENT ON THE PART OF THE RECIPIENT TO THESE CONDITIONS IS PRESUMED

DRFTR RWB 2/4/10

CHKR

ENGR

MGR

BY DATE

STK No:

MAT'L:

DESCR. BALL STRAIGHT LLB METER VALVE w/ HANDLE (FIP x METER FLANGE)

DWG NUMBER E1913WJ