

No.	DESCRIPTION	MATERIAL DESCRIPTION
1	BODY	CAST LOW LEAD BRASS ALLOY
2	CAP	CAST BRASS ASTM B62 ALLOY C83600
3	STEM	LOW LEAD BRASS ALLOY
4	BALL	LOW LEAD BRASS ALLOY
5	GASKET	DYNEON TFMI600 OR DUPONT PTFE TE-6473
6	SOLID PIN	AISI 304 STAINLESS STEEL
7	O-RING	ASTM D2000 (EP)
8	END PIECE	CAST LOW LEAD BRASS ALLOY
9	O-RING	ASTM D2000 (EP)
10	CTS GASKET SUB	ASTM D2000(SBR)&410 STAINLESS STEEL
11	CONN NUT	CAST BRASS ASTM B62 ALLOY C83600
12	O-RING	ASTM D2000 (EP)

SIZE	ØA	B	C	D	E
3/4"	.75	3.59	.84	2.43	3.27
1"	1.00	5.02	1.05	2.67	3.73
1-1/2"	1.50	5.06	1.66	3.37	5.03
2"	2.00	5.22	1.82	3.92	5.74

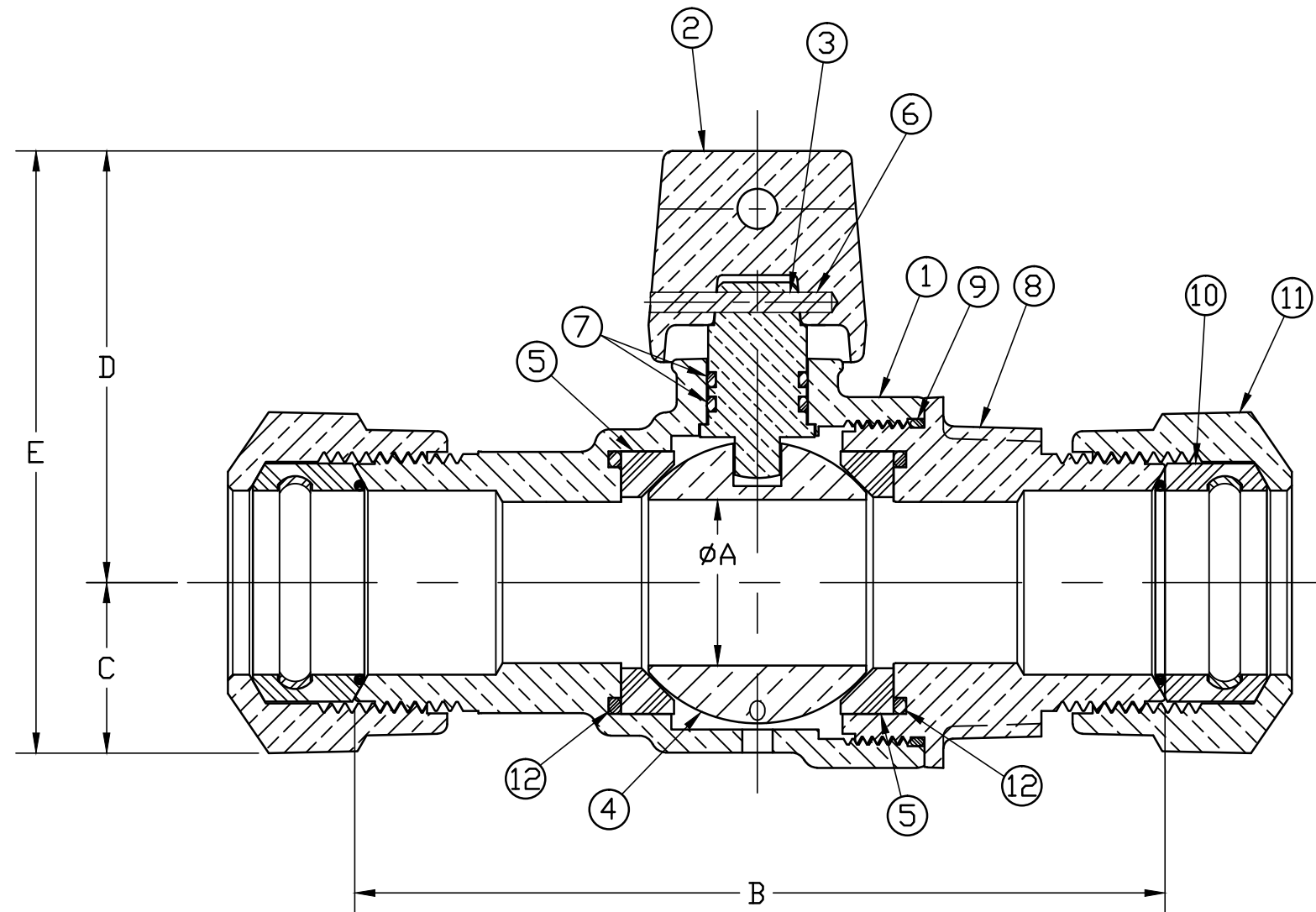

ALL WETTED PARTS ARE LOW LEAD BRASS ALLOY

FILEPATH: PRODD-ENG\JAMES JONES\ASYSUBMITTALS\E6501SG

DRFTR	RWB	4/22/16	JONES	UNLESS OTHERWISE NOTED THIRD ANGLE PROJECTION SURFACE PREPARATION: BREAK CORNER(S) ---- .000 SURFACE FINISH -- XX RMS TOLERANCE(S): LINEAR ----- ± .000 ANGULAR ----- ± 0°00'
CHKR				
ENGR				
MGR				
	BY	DATE	REF. No.	SCALE
				FULL
	STK No:		DWG NUMBER	
	MAT'L:		E6501SG	
	DESCR:	PER EST NO: DXXXX EST FIN WT = 0.0000 lbs	E6501SG	
			E6501SG	

DWG NUMBER
E6501SG
JJ-MRKTG

TITLE TO AND OWNERSHIP OF THIS ENGINEERING DATA REMAINS IN Mueller Co. NO USE IS TO BE MADE OF THIS DATA EXCEPT AS SPECIFICALLY AUTHORIZED BY Mueller Co. ASSENT ON THE PART OF THE RECIPIENT TO THESE CONDITIONS IS PRESUMED.