

NOTE:
1. THIS IS A REFERENCE DIMENSION ONLY.
ACTUAL DIMENSIONS MAY VARY WITH TIGHTNESS
OF VALVE AND CAP.

CHART 1		
CAST NUMBER	WORKING PRESSURE	MODEL NUMBER
34-0246	250 PSI	4060
34-0279	350 PSI	4060HP

ITEM	DESCRIPTION	REQ'D	MATERIAL	A.S.T.M.		PART NUMBERS
1	HYDRANT BODY	1	DUCTILE IRON	A536	65-45-12	SEE CHART
2	NOZZLE INSERT - 2-1/2"	2	BRASS	B584	C89833	34-0113
3	NOZZLE INSERT - 4" / 4-1/2"	1	BRASS	B584	C89833	34-0117
4	O-RING	6	RUBBER	D2000	NITRILE	194572
5	O-RING	3	RUBBER	D2000	NITRILE	15-0192
6	HOSE NOZZLE O-RING	2	RUBBER	D2000	NITRILE	15-0242
7	PUMPER NOZZLE O-RING	1	RUBBER	D2000	BUNA N	15-0243
8	STEM - SHORT	1	BRASS	B584	C87600	26-0089
9	STEM - LONG	2	BRASS	B584	C87600	26-0093
10	INSERT 2-1/2" SHORT LENGTH	1	BRASS	B584	C89833	34-0688
11	INSERT 2-1/2" MEDIUM LENGTH	1	BRASS	B584	C89833	34-0689
12	INSERT 4" / 4-1/2" LONG LENGTH	1	BRASS	B584	C89833	34-0690
13	ASSY - HOLDER AND DISC 2-1/2"	2	BRASS	B584	C89833	27-0500
14	ASSY - HOLDER AND DISC 4" & 4-1/2"	1	BRASS	B584	C89833/C89836	27-0501
15	CAP - 2-1/2" W/CHAIN	2	CAST IRON	A126		23-0168
16	CAP - 4" / 4-1/2" W/CHAIN	1	CAST IRON	A126		23-0176
17	LOCKNUT - STEM	3	BRASS	B584	C89833	16-0016
18	NUT - OPERATING	3	BRASS	B584	C87600	21-0016
19	NUT - STEM	3	BRASS	B584	C83600	16-0254
20	SET SCREW	3	STAINLESS STEEL		S30200/S30300	20-0026
21	S-HOOK	2	STEEL		ZINC CHROMATE PLATED	30-0021
22	GASKET 2-1/2"	2	RUBBER	D2000	NEOPRENE	290272
23	GASKET 4" / 4-1/2"	1	RUBBER	D2000	NEOPRENE	192345
24	CHAIN	2	STEEL		ZINC CHROMATE PLATED	30-0003

4-1/2" NOZZLE CONFIGURATION PART NUMBERS SHOWN FOR REFERENCE.

SEE CAT. RECORD FOR RESPECTIVE PARTS OR SUB. ASSEMBLIES

* 5" STORZ IS AVAILABLE FOR 250 PSI MODEL (4060) ONLY.

HYDRANT DESCRIPTION		
PART#	NOZZLE CONFIGURATION	FLANGE PATTERN
J4060AR	4-1/2" X 2-1/2" X 2-1/2"	6 - 0.75" HOLES, 9.38" DBC
J4060BR	4" X 2-1/2" X 2-1/2"	8 - 0.88" HOLES, 9.5" DBC
J4060CR	4" X 2-1/2" X 2-1/2"	6 - 0.88" HOLES, 9.5" DBC
J4060DR	4" X 2-1/2" X 2-1/2"	6 - 0.75" HOLES, 9.38" DBC
J4060ER	4-1/2" X 2-1/2" X 2-1/2"	8 - 0.88" HOLES, 9.5" DBC

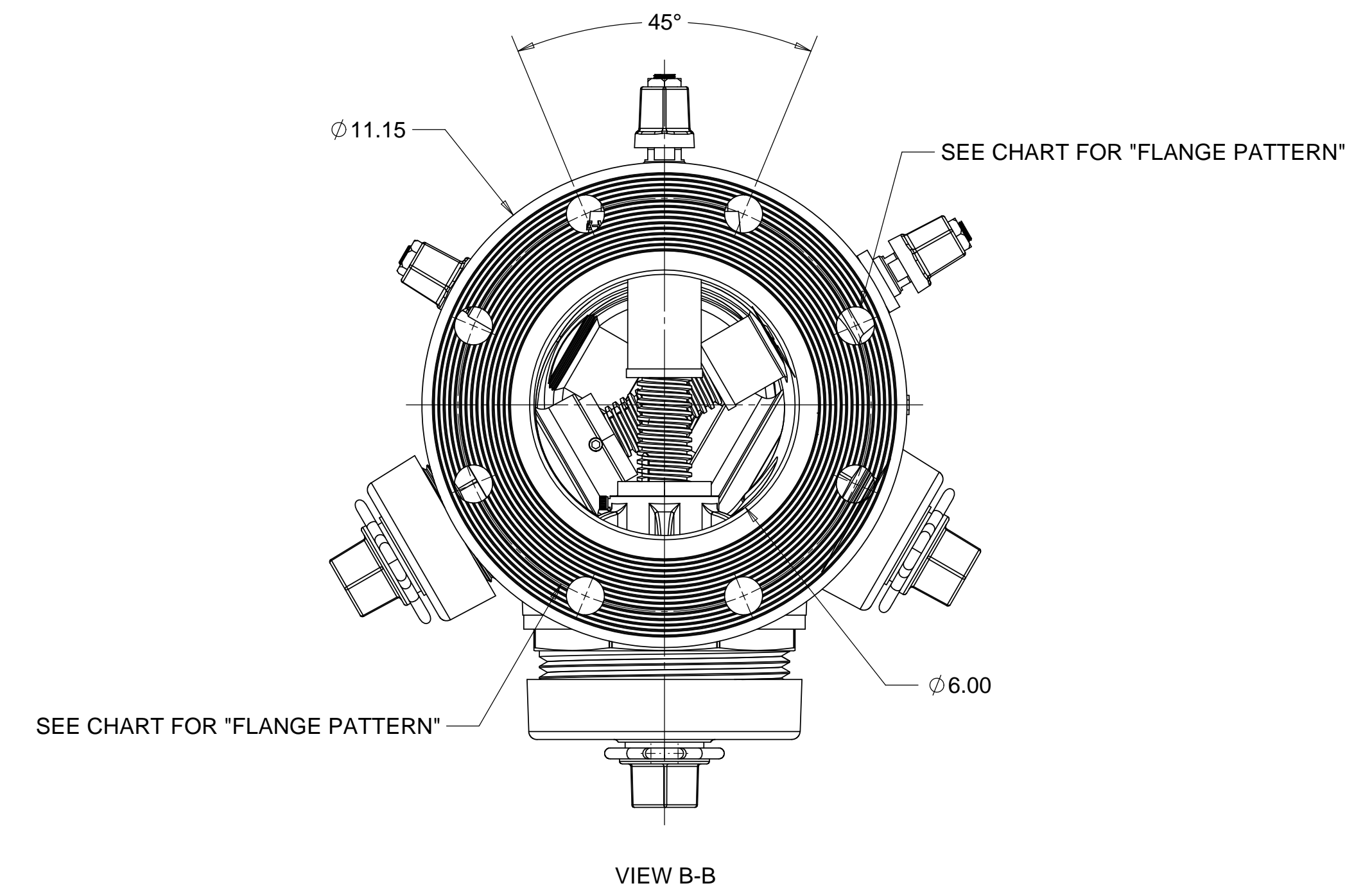
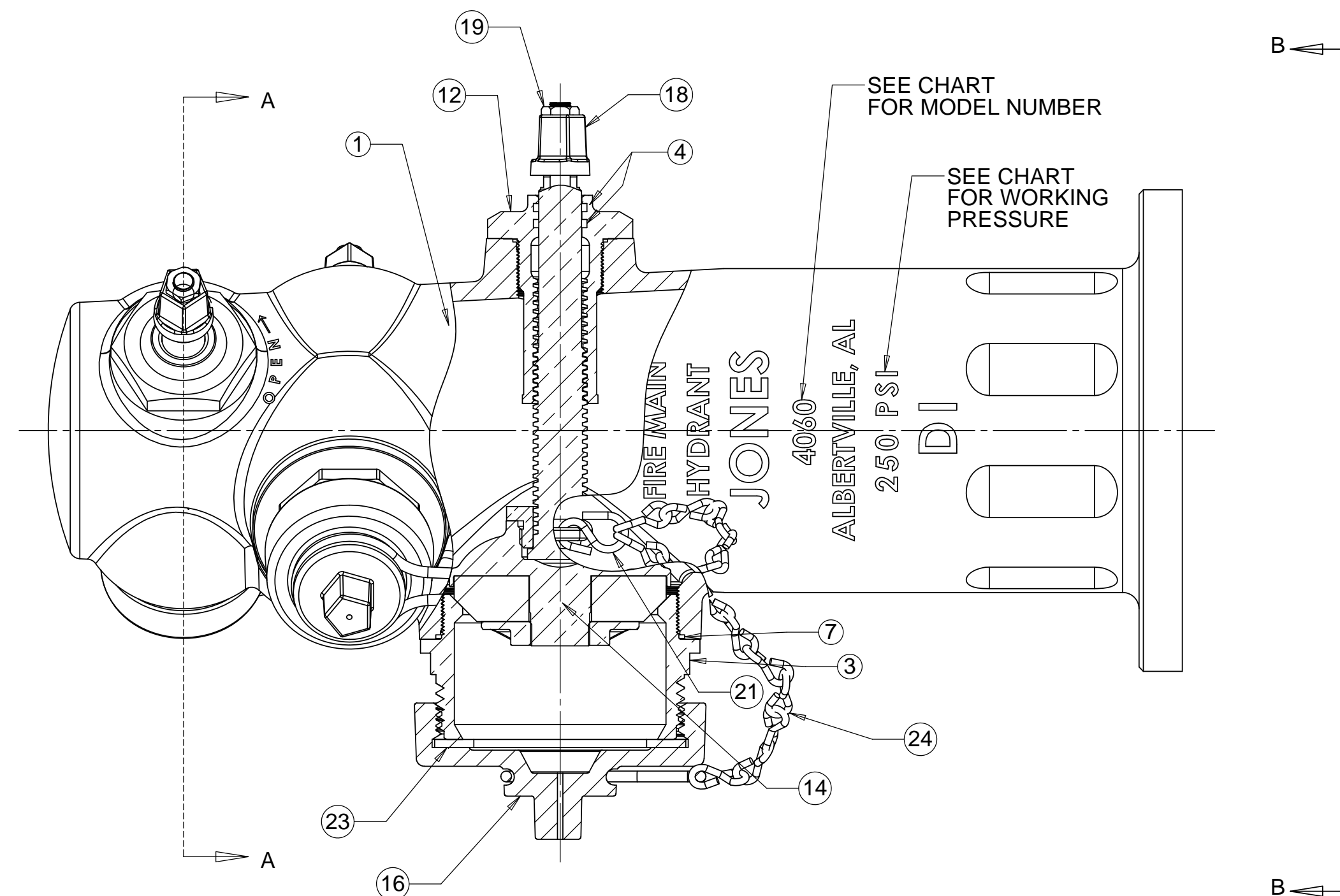
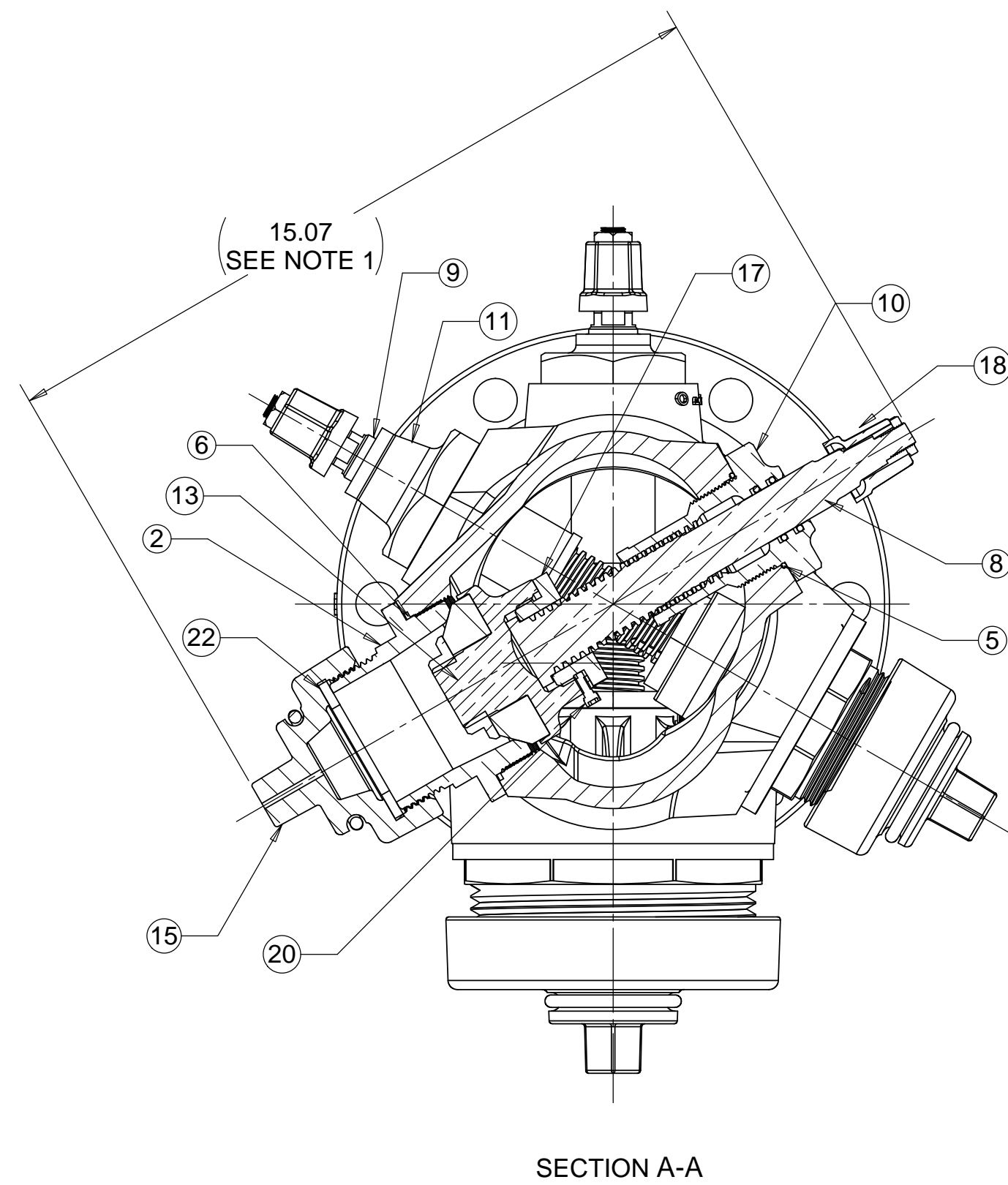

DWG. No. FH-573

REV.	DESCRIPTION	REF.	DATE
C	ADD 'HYDRANT DESCRIPTION' TABLE	ANC	12-9-16
B	REVISE PT# ON ITEM# 18 FROM 21-0004 TO 21-0016	EO4032 ANC	11-16-16
A	ADD TABLE WITH MODEL NUMBER AND PRESSURE RATING	JBC	6/19/15

SUBMITTAL DRAWING:
INTENDED FOR INFORMATIONAL
PURPOSES ONLY.

DIMENSIONS		TOLERANCES		FINISHES	
INCH	MILLIMETER	UNLESS OTHERWISE NOTED	UNLESS OTHERWISE NOTED	FINISH	THIRD ANGLE PROJECTION
±0.005	±0.127	±0.005	±0.127	BLK EDGES	FINISH
±0.002	±0.051	±0.002	±0.051	MAC 0.006/0.016	FINISH
±0.001	±0.025	±0.001	±0.025	FINISH SURFACE	FINISH
±0.0005	±0.013	±0.0005	±0.013	125	FINISH
±0.0002	±0.005	±0.0002	±0.005	175	FINISH
±0.0001	±0.002	±0.0001	±0.002	200	FINISH
±0.00005	±0.001	±0.00005	±0.001	250	FINISH
±0.00002	±0.0005	±0.00002	±0.0005	300	FINISH
±0.00001	±0.0002	±0.00001	±0.0002	350	FINISH
±0.000005	±0.0001	±0.000005	±0.0001	400	FINISH
±0.000002	±0.00005	±0.000002	±0.00005	450	FINISH
±0.000001	±0.00002	±0.000001	±0.00002	500	FINISH
±0.0000005	±0.00001	±0.0000005	±0.00001	550	FINISH
±0.0000002	±0.000005	±0.0000002	±0.000005	600	FINISH
±0.0000001	±0.000002	±0.0000001	±0.000002	650	FINISH
±0.00000005	±0.000001	±0.00000005	±0.000001	700	FINISH
±0.00000002	±0.0000005	±0.00000002	±0.0000005	750	FINISH
±0.00000001	±0.0000002	±0.00000001	±0.0000002	800	FINISH
±0.000000005	±0.0000001	±0.000000005	±0.0000001	850	FINISH
±0.000000002	±0.00000005	±0.000000002	±0.00000005	900	FINISH
±0.000000001	±0.00000002	±0.000000001	±0.00000002	950	FINISH
±0.0000000005	±0.00000001	±0.0000000005	±0.00000001	1000	FINISH
±0.0000000002	±0.000000005	±0.0000000002	±0.000000005	1050	FINISH
±0.0000000001	±0.000000002	±0.0000000001	±0.000000002	1100	FINISH
±0.00000000005	±0.000000001	±0.00000000005	±0.000000001	1150	FINISH
±0.00000000002	±0.0000000005	±0.00000000002	±0.0000000005	1200	FINISH
±0.00000000001	±0.0000000002	±0.00000000001	±0.0000000002	1250	FINISH
±0.000000000005	±0.0000000001	±0.000000000005	±0.0000000001	1300	FINISH
±0.000000000002	±0.00000000005	±0.000000000002	±0.00000000005	1350	FINISH
±0.000000000001	±0.00000000002	±0.000000000001	±0.00000000002	1400	FINISH
±0.0000000000005	±0.00000000001	±0.0000000000005	±0.00000000001	1450	FINISH
±0.0000000000002	±0.000000000005	±0.0000000000002	±0.000000000005	1500	FINISH
±0.0000000000001	±0.000000000002	±0.0000000000001	±0.000000000002	1550	FINISH
±0.00000000000005	±0.000000000001	±0.00000000000005	±0.000000000001	1600	FINISH
±0.00000000000002	±0.0000000000005	±0.00000000000002	±0.0000000000005	1650	FINISH
±0.00000000000001	±0.0000000000002	±0.00000000000001	±0.0000000000002	1700	FINISH
±0.000000000000005	±0.0000000000001	±0.000000000000005	±0.0000000000001	1750	FINISH
±0.000000000000002	±0.00000000000005	±0.000000000000002	±0.00000000000005	1800	FINISH
±0.000000000000001	±0.00000000000002	±0.000000000000001	±0.00000000000002	1850	FINISH
±0.0000000000000005	±0.00000000000001	±0.0000000000000005	±0.00000000000001	1900	FINISH
±0.0000000000000002	±0.000000000000005	±0.0000000000000002	±0.000000000000005	1950	FINISH
±0.0000000000000001	±0.000000000000002	±0.0000000000000001	±0.000000000000002	2000	FINISH

JAMES JONES COMPANY		SEE TABLE		REVISIONS	
DATE	BY	DATE	BY	NO.	DESCRIPTION
12/9/16	ANC	11/16/16	EO4032	1	REVISED FOR 21-0016
6/19/15	JBC			2	REVISED FOR 21-0004
				3	REVISED FOR 21-0004
				4	REVISED FOR 21-0004
				5	REVISED FOR 21-0004
				6	REVISED FOR 21-0004
				7	REVISED FOR 21-0004
				8	REVISED FOR 21-0004
				9	REVISED FOR 21-0004
				10	REVISED FOR 21-0004
				11	REVISED FOR 21-0004
				12	REVISED FOR 21-0004
				13	REVISED FOR 21-0004
				14	REVISED FOR 21-0004
				15	REVISED FOR 21-0004
				16	REVISED FOR 21-0004
				17	REVISED FOR 21-0004
				18	REVISED FOR 21-0004
				19	REVISED FOR 21-0004
				20	REVISED FOR 21-0004
				21	REVISED FOR 21-0004
				22	REVISED FOR 21-0004
				23	REVISED FOR 21-0004
				24	REVISED FOR 21-0004
				25	REVISED FOR 21-0004
				26	REVISED FOR 21-0004
				27	REVISED FOR 21-0004
				28	REVISED FOR 21-0004
				29	REVISED FOR 21-0004
				30	REVISED FOR 21-0004
				31	REVISED FOR 21-0004
				32	REVISED FOR 21-0004
				33	REVISED FOR 21-0004
				34	REVISED FOR 21-0004
				35	REVISED FOR 21-0004
				36	REVISED FOR 21-0004
				37	REVISED FOR 21-0004
				38	REVISED FOR 21-0004
				39	REVISED FOR 21-0004
				40	REVISED FOR 21-0004
				41	REVISED FOR 21-0004
				42	REVISED FOR 21-0004
				43	REVISED FOR 21-0004
				44	REVISED FOR 21-0004
				45	REVISED FOR 21-0004
				46	REVISED FOR 21-0004
				47	REVISED FOR 21-0004
				48	REVISED FOR 21-0004
				49	REVISED FOR 21-0004
				50	REVISED FOR 21-0004
				51	REVISED FOR 21-0004
				52	REVISED FOR 21-0004
				53	REVISED FOR 21-0004
				54	REVISED FOR 21-0004
				55	REVISED FOR 21-0004
				56	REVISED FOR 21-0004
				57	REVISED FOR 21-0004
				58	REVISED FOR 21-0004
				59	REVISED FOR 21-0004
				60	REVISED FOR 21-0004
				61	REVISED FOR 21-0004
				62	REVISED FOR 21-0004
				63	REVISED FOR 21-0004
				64	REVISED FOR 21-0004
				65	REVISED FOR 21-0004
				66	REVISED FOR 21-0004
				67	REVISED FOR 21-0004
				68	REVISED FOR 21-0004
				69	REVISED FOR 21-0004
				70	REVISED FOR 21-0004
				71	REVISED FOR 21-0004
				72	REVISED FOR 21-0004
				73	REVISED FOR 21-0004
				74	REVISED FOR 21-0004
				75	REVISED FOR 21-0004
				76	REVISED FOR 21-0004
				77	REVISED FOR 21-0004
				78	REVISED FOR 21-0004
				79	REVISED FOR 21-0004
				80	REVISED FOR 21-0004
				81	REVISED FOR 21-0004
				82	REVISED FOR 21-0004
				83	REVISED FOR 21-0004
				84	REVISED FOR 21-0004